

User Manual

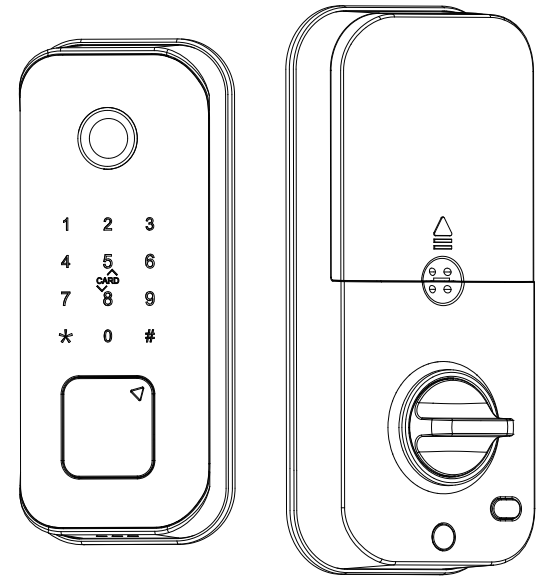

Please read and understand the Operating Manual before use.

Caution: Please take along an emergency key or put it in a safe place outside.

► **Instructions for use**

- Warm tips:** Please prepare 1 cross screwdriver and drilling machine before installment.
1. The Smart lock is in demo mode in its initial state. Please set the administrator information before using it.
 2. After setting the administrator information, touch the button area to enter the correct password and then press the # to unlock.
 3. In case of unlocking, if the battery is running low, "short beep sound" will be prompted for 4 times in a 2-round cycle, and the keyword light will flash. When there is a prompt of battery low, please replace battery in a timely manner, and the door can still be opened for 200 times
 4. Please do not scratch the surface with corrosive or sharp items to prevent the lock surface from being damaged.
 5. When the battery is running low or the electric part is out of order, an emergency key can be used to unlock outside, please take good care of the key and keep it in a safe place outdoors.
 6. After assembly, the door must be kept in an open state so as to conduct commissioning and initialized parameter setting.
 7. Operating temperature: -25 ~+70°C.

► **Packing list**

S/N	Content	Quantity
1	Front lock	1
2	Rear lock	1
3	Lock body (Including key*2)	1
4	Manual	1
5	Installation accessories package	1
6	Opening template	1

► **Product functional characteristics**

- 

Key unlock
- 

Password unlock
- 

Standard lock cylinder
- 

Live voice Tipes
- 

Low voltage alarm
- 

Virtual password
- 

Autolock
- 

Fingerprint unlock
- 

Remote unlocking
(Choose a package)

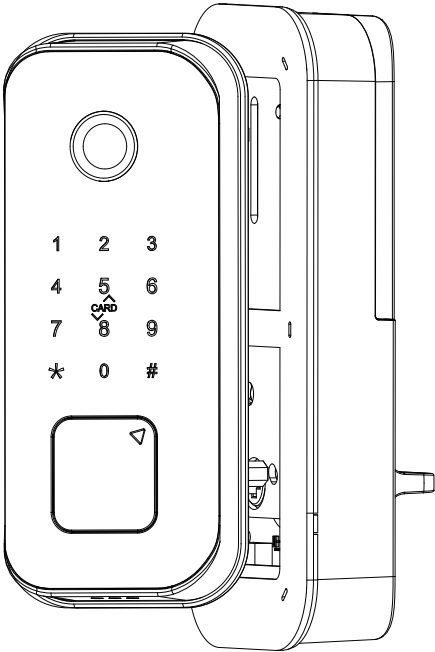

► Schematic Diagram of Product Breakdown

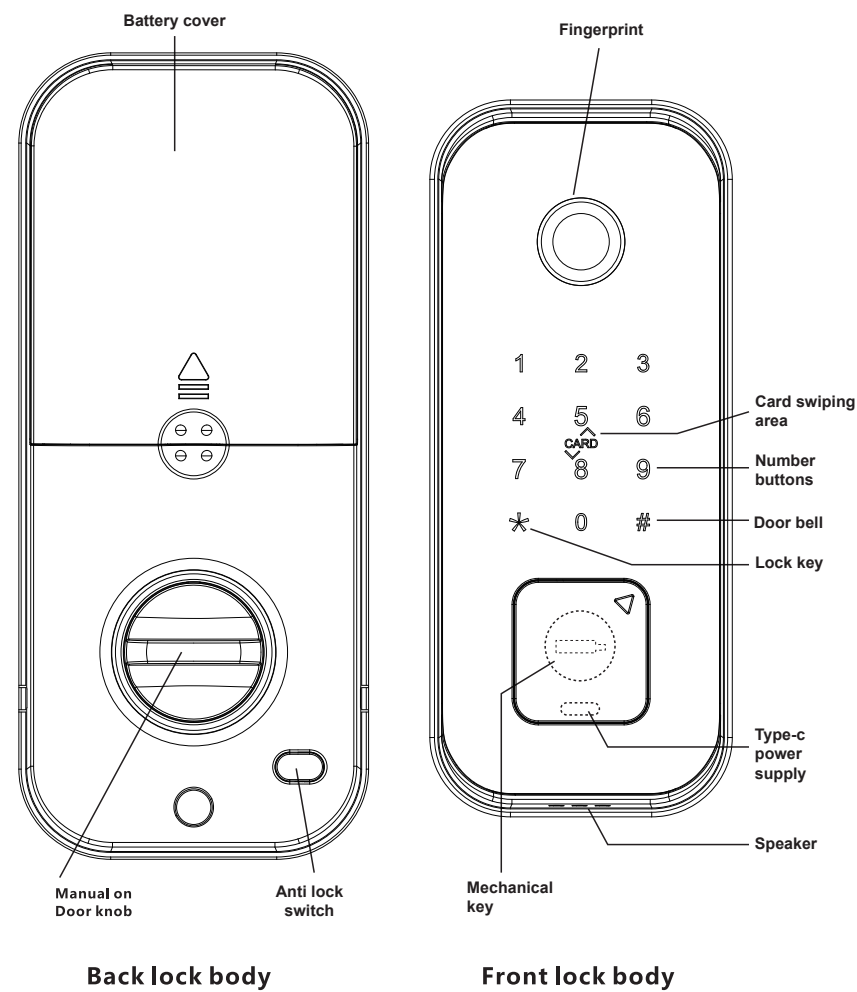

► Product size

Front lock body
unit:mm

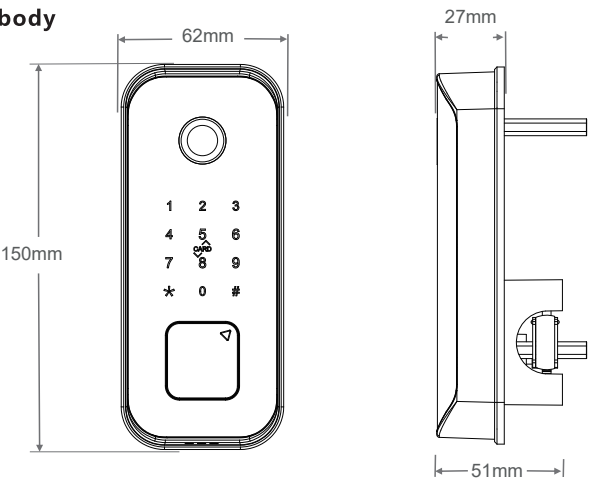

Back lock body
unit:mm

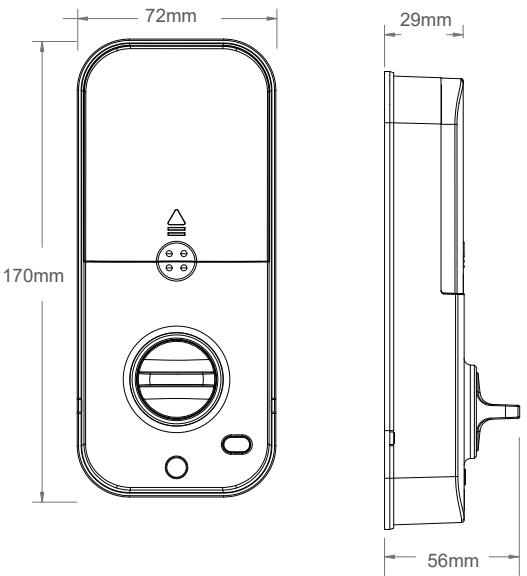

► Product specification and how to operate the menu

Name	Content
Unlock type	Fingerprint, password, IC card, key
Storage capacity	100 fingerprints, 100 sets of passwords, and 100 sets of IC cards
Power supply	4 sections of 5th alkaline batteries
Voice	human voice
Low voltage alarm	≤4.8V
Antistatic	Exposure +/-8KV Air +/-15KV
Standby current	<70uA
Dynamic power consumption	<200mA
Operating environment	-25°C~+70°C
Operating temperature	0%~95%
Applicable door thickness	35MM-55MM
Power supply interface	USB Type-C DC 5V/1A

► Identify Left/Right Hand Door

Stand by oUTSIDE facing the keypad.

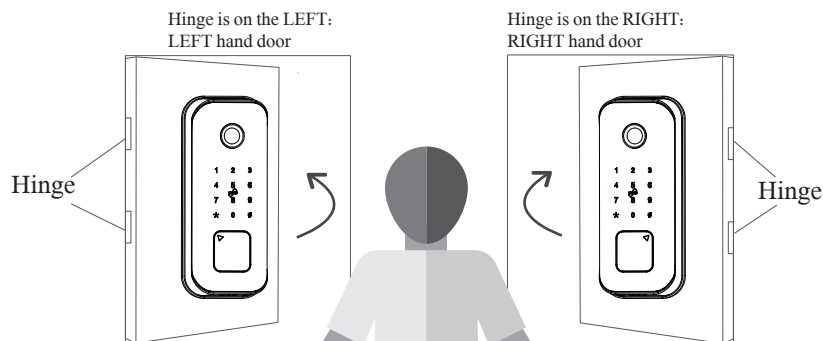

► Installation

Installation

1. Installation Instructions

- While installing and commissioning, please stand in the room all the time.
- While installing the front panel, keep the logo up and pass the connection wire under the lock body, keep the bump of the paddle faces upwards and fits into the lock body.
- After the installation is completed, check whether the password 123456, mechanical key, knob work ok or not.
- If it does not work properly, please check whether there has been an error installation or loose power cord connector during installation.

2. Open Hole

Please refer to the open hole drawing, and drill correct holes on the door.

Notes:

- The distance between door edge and lock body center can be 60mm or 70mm.
- The diameter of the open hole can be 38-54 mm.
- If the diameter of the door open hole is less than 52mm, the front panel block shall be removed.
- Install Lock Body

1. According to the central position of the open hole of the door, adjust the position of the pick jack of the lock body.

- Hold the head of the lock body with your hand.
- Turn the lock tail clockwise or counter-clockwise, adjust the position of the pick jack of the lock body to 60 mm or 70 mm.
- Insert and turn the paddle to test whether the lock body switch is ok or not.

2. The mark 'UP' face UP and fit the lock body.

3. Twist 2 tapping screws.

4. Install Lock

1. Install the Front Panel

a. Pass the connection wire under the lock body.

Note: Do not pass the connection wire above the lock body.

b. Adjust the paddle to the horizontal direction, keep the bump of the paddle faces upwards and fits into the pick jack of the lock body.

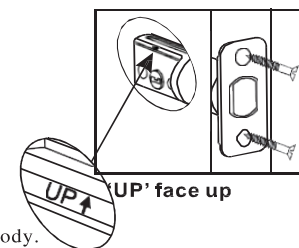
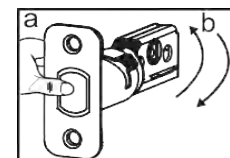
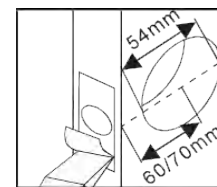

► Installation

c. Fix the front panel the outdoors.

d. The iron plate is fixed on the inner side of the door through the connection wire so that the pick is centered.

Note: 1. The convex stud face outward.

2. The door thickness is less than 39mm, one section of the paddle need be cut off

f. Adjust the front panel and the iron plate so that they are upright.

g. The connection wire is wound into the slot on the right.

Note: If you feel that the front lock is not fixed, you can remove the front panel and the iron plate. A round hole with a diameter of 20 mm is made on the door body from 77mm above the center point of the door hole. Then use the standby connection column and connection column screw (M4 * 25mm) to reinforce the fixing.

4.2 Install The Back Panel

a. Remove the back cover, pass the connection wire through the back panel, and straighten.

b. Turn the KNOB to the vertical position and align the pick to the door.

c. Turn the KNOB to check the latch switch is ok.

d. Lock 2 back panel screws (M4 * 35mm) and 1 back panel screw (M4 * 25mm), shake the front and back panel to ensure the front and back panel is tight.

back panel. The excess wire is hidden in the back cover frame. Install the back cover.

f. Install 4 AA batteries and the battery cover.

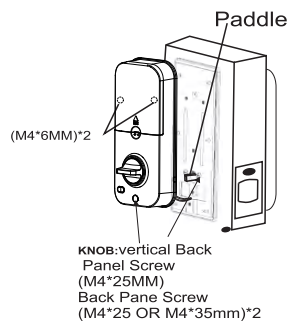
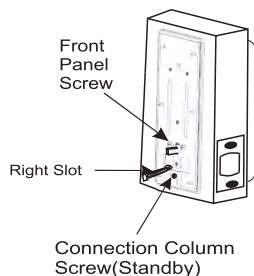
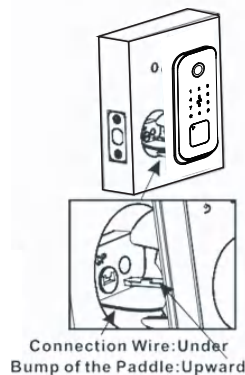

► Operating process

1.1 System initialization

After installing the battery, keep pressing the reset button for 8 seconds to indicate successful initialization and return to demonstration mode, clear all settings.

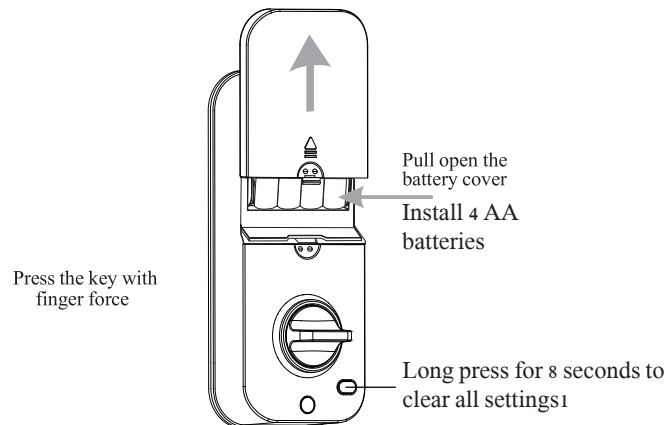

1.2 Setting unlocking direction

Press * 61 # management password # to change to the Left Status.

Press * 62 # management password # to change to the Right Status.

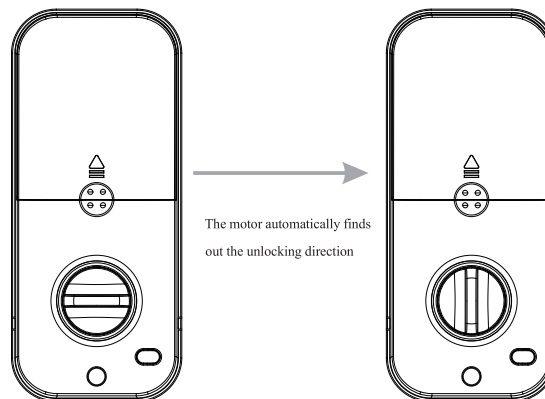

► Operating process

Notes:

A: The [*] on the keypad can be used to return to the previous menu, clear the input content, and exit the system/menu.

B: The [#] on the keypad is used to operate all entered confirmation keys and doorbell functions.

C: Wake up the keypad and enter [* #] to enter the menu.

(After having the administrator password, you need to enter the " *#+ administrator password #" to enter the menu.)

Press[* #] to enter the menu

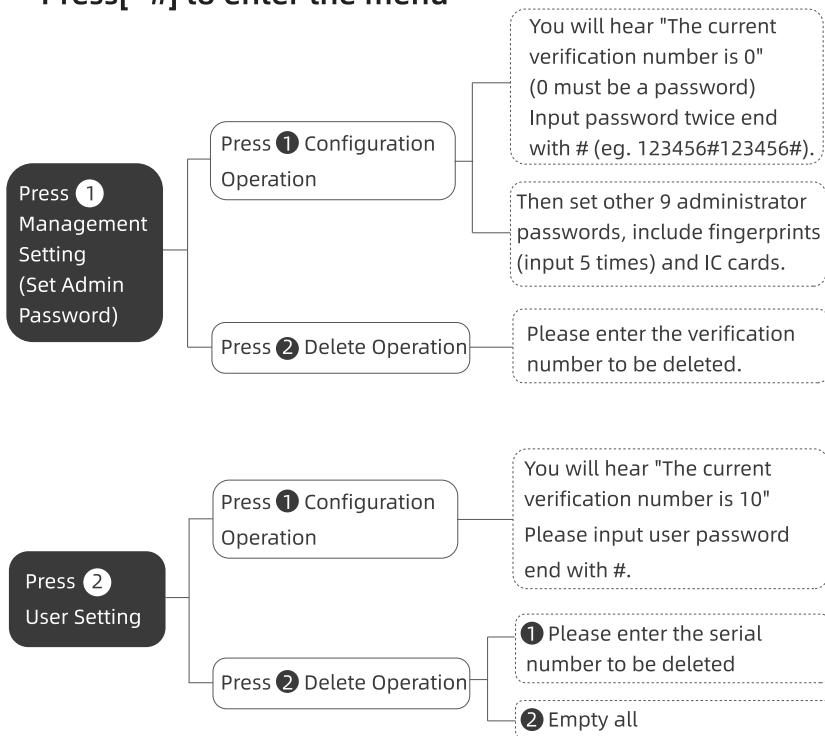

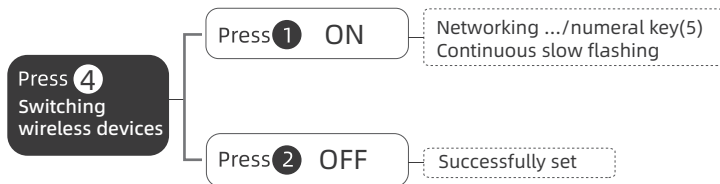

Optional: Tuya Smart WiFi Setting Guide

[Remote unlocking Choose a package]

Step 1: Search for "Tuya Smart" in Android play store or App store to download and install. Create a new account, you can register and login by email or cell phone number.



Scan code
download App

Step 2: Open the App and click "+" to add device -- camera/lock -- lock WiFi -- Select 2.4Ghz, select WiFi and input password. Click Next. Turn on the wireless device on the smart lock - button '5' is flashing - pairing is complete.

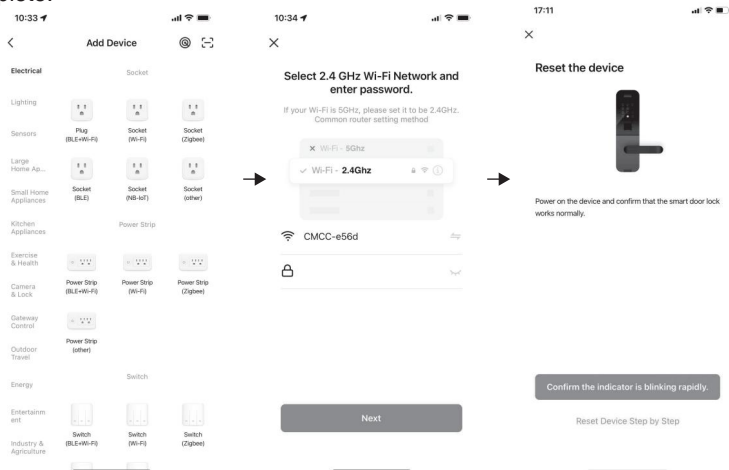

Step 3: After pairing is completed, press(##) on the smart lock to send a WiFi remote unlock command. After 5-10 seconds, Tuya App will notify - prompt whether to open the door - click OK to open the door.

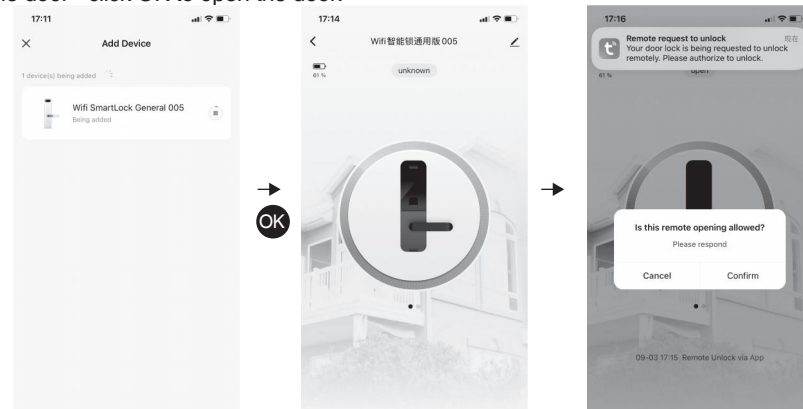

Operating process

Manual on/off lock and privacy anti lock function

1. Manual opening knob: When the battery is dead and people are inside, you can manually rotate the door opening knob to open/close the door. Attention: The door opening direction can only be rotated 90 degrees in one direction.
2. Press and hold the (O) button for 2 seconds, and the voice will indicate that the anti-lock in on. Then only the administrator's fingerprint/password can unlock it, and others cannot unlock it.
3. Press and hold the (O) button for 2 seconds, and the voice will indicates that the anti-lock is off. The fingerprint passwords of both administrators and general users can unlock it.

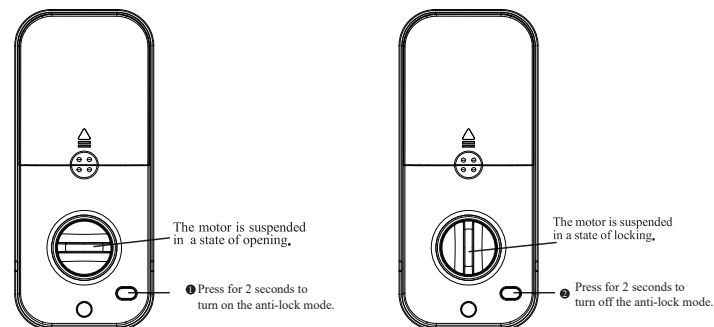

► Precautions

1. Prohibit any disassembly at will

The product is composed of precise and complex components, please do not disassemble any structures inside to avoid operation abnormalities of the product or other use danger resulting from this. If you need to disassemble, again, please contact a professional.

2. Choose cleaning method carefully

Please clean the product with dry cloth, water is prohibited to clean the product to avoid power failure.

3. Measures to cope with battery running low or out of power

a. Prompt of battery running low Please replace the battery with a voice reminder

The keyboard light will flash, at this time, please change the battery in a timely manner

